

Zebra DS457 Scanner Configuration



The Zebra DS457 Scanner must be configured to work correctly with Gym Assistant. No drivers need to be installed, but a properly configured USB/Serial (RS232) adapter is required.

Connect the Scanner

Connect the power supply to the scanner cable.

Connect the scanner serial cable to your USB/Serial adapter.

In **GateKeeper** select **Access Points / Ports** from the **Settings** menu.

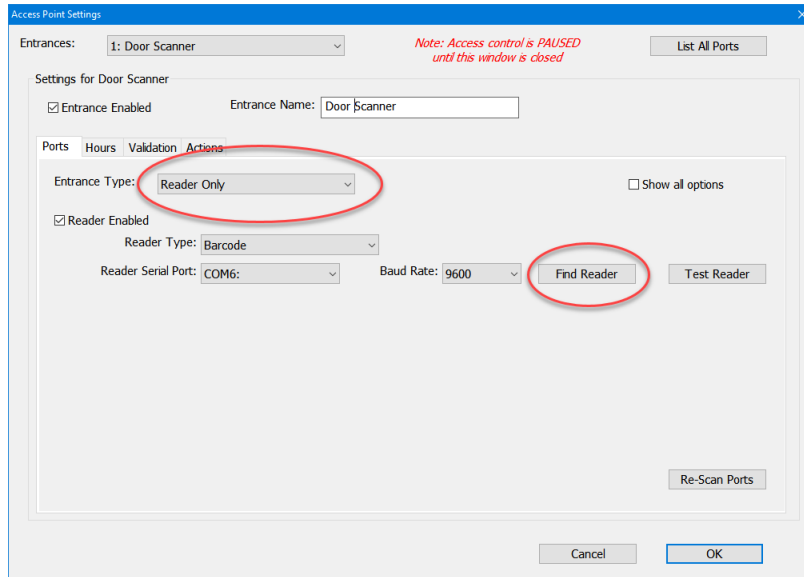

Set the **Entrance Type** to **Reader Only**.

Set the **Reader Type** to **Barcode**.

Click the **Find Reader** button.

The scanner will beep three times and the LED on the reader will turn green, which indicates that the reader is connected to an open serial (RS232) port.

GateKeeper will display "Looking for Reader. SCAN CARD NOW".

Configure the Scanner

Scan the two barcodes below in order. On each scan the reader will play a little song, but note that nothing will change in GateKeeper.



DS457 Programming Barcode(1 of 2)



DS457 Programming Barcode(2 of 2)

Test the Scanner

Now scan the test barcode below:



Test Barcode

GateKeeper should now report that “Reader was found on COMx”.

Click OK, then click OK again.

Now scan a keytag. GateKeeper should display **Unknown Scan: ‘XXXXX’**.

You are now ready to go!